

PAIR DOOR, SURFACE MOUNT (PUSH) OFFSET PIVOT/BUTT HINGE



The 9150 BENCHMARK by LCN is an electrically powered low-energy operator. It provides easy access for people with disabilities, the elderly or the frail. Designed primarily for automatic opening applications that occasionally require manual opening. The BENCHMARK is a cost-effective solution for retrofitting an activated or manual door.

- ▶ Push 'N Go permits non-switch activation
- ▶ Microprocessor control box ensures reliability and maintains customer settings
- ▶ Tested internally to over 3,000,000 cycles
- ▶ Power Boost allows for increased closing force near latch

- ▶ 9150 series operator is shipped with motor gearboxes, control boxes, mounting plate, regular arms, metal cover, wood and machine screw packs. Actuators available separately, see pages 199-215.
- ▶ Pair of interior doors, surface mounted.
- ▶ ADA compliant.
- ▶ On/Off switch included as standard.
- ▶ Non-handed for either right or left swinging door.
- ▶ 72" cover is standard. Full length covers up to 96" for pairs of doors.
- ▶ All potentiometers clearly labeled with their functions.
- ▶ LED lights indicate power to control box and motor gearbox.

9150 Series is fully compliant with UL 325 and meets the provisions of ANSI A156.19. The 9150 Series is UL listed for fire-rated applications. The 9150 Series also meets the provisions of the Americans with Disabilities Act.

MOUNTING			HANDING			FINISH	COVER		ARM FUNCTION		
<input type="radio"/>	<input type="radio"/>	<input type="radio"/>	<input type="radio"/>	<input type="radio"/>	<input type="radio"/>	<input type="radio"/>	<input type="radio"/>	<input type="radio"/>	<input type="radio"/>	<input type="radio"/>	<input type="radio"/>
<input type="radio"/>	<input checked="" type="radio"/>	<input checked="" type="radio"/>	<input type="radio"/>	<input type="radio"/>	<input type="radio"/>	<input checked="" type="radio"/>	<input type="radio"/>	<input type="radio"/>	<input type="radio"/>	<input type="radio"/>	<input type="radio"/>
SURFACE MOUNT SINGLE DOOR			HANDED			STANDARD ANODIZED	STANDARD (SINGLE)		REGULAR (SINGLE)		
SURFACE MOUNT SIMULTANEOUS PAIR			NON-HANDED			CUSTOM ANODIZED	REGULAR (DOUBLE)		DOUBLE EGRESS (PUSH/PULL)		
CONCEALED SINGLE DOOR						CUSTOM PAINT	DOUBLE EGRESS (PUSH/PULL)		OFFSET PIVOT ARM		
CONCEALED SIMULTANEOUS PAIR						METAL	OFFSET PIVOT ARM		CENTER PIVOT ARM		

● AVAILABLE
○ NOT AVAILABLE

LCN 9150 SERIES

MOUNTING DETAILS

TOP JAMB, INDEPENDENT/SIMULTANEOUS PAIR (OFFSET PIVOT/BUTT HINGE, CENTER PIVOT, PUSH) MOUNTING

Determined by wiring method
during installation.

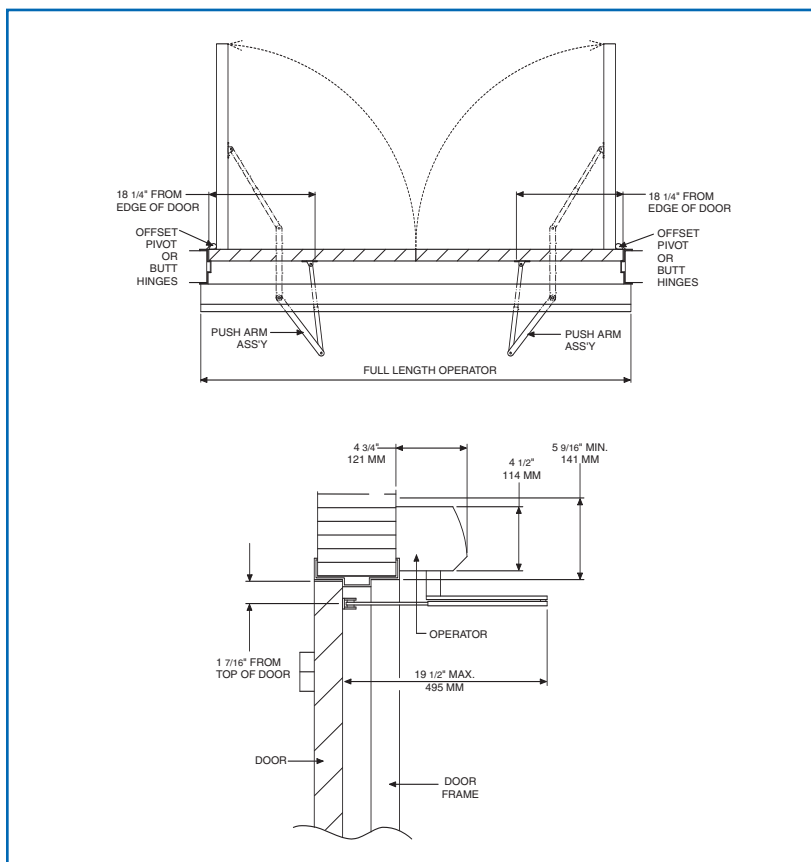

MAXIMUM OPENING

Template allows 90 degree power
opening and 90 degree manual
opening.

Special Templates

Customized installation templates
or products may be available to
solve unusual applications.
Contact LCN for assistance.

- ▶ **Butt Hinges** should not exceed 5" (127 mm) in width.
- ▶ **Reveal** for push installations should not exceed 6" (152 mm) for REGULAR ARM and 9 3/4" (248 mm) for LONG ARM.
- ▶ **Head Frame** minimum 2" (51 mm).
- ▶ **Top Rail** minimum 2" (51 mm). Flush ceiling installation requires 5 1/4" (133 mm) minimum.
- ▶ **Opening and Closing Time** are variable by adjustments to the electronic control module located on the operator assembly. Maximum hold open time adjustable up to approximately 32 seconds.
- ▶ **System Diagram** see "AUTOMATIC OPERATORS" section pages 56-57 for typical system wiring and page 58 for electrical data.
- ▶ Please consult your local SSC representative or LCN for assistance with specific installations and material requirements.

MOTOR GEARBOX

MOTOR GEARBOX ASSEMBLY, 9150-3454S

Driving mechanism for operator. For 27" unit. Switch included.

MOTOR GEARBOX ASSEMBLY (W/O SWITCH), 9150-3454

Driving mechanism for operator. For full length unit. Switch not included.

BRACKETS

MOUNTING BRACKET, 9150-3018

Standard mounting bracket.

CONTROL BOXES

CONTROL BOX, (120v), 9130-3462

Electronic controlling device with power supply output and power boost feature for Benchmark.

COVERS

METAL COVER, 9150-72MC

Standard, 72", non-handed, extruded aluminum cover.

FULL METAL COVER, 9150-72FC

Full length, non-handed, extruded aluminum cover. Specify length 52" to 98".

COVER INSERT 9150-163

Used to cover operator shaft opening.

COVER END CAP INSERT, 9150-163-1

Used to cover switch hole opening.

COVER END CAP, 9150-334

Black plastic end caps.

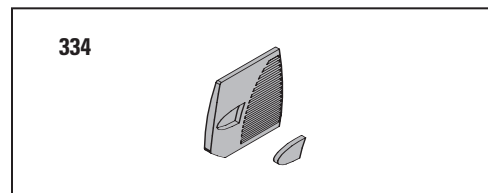
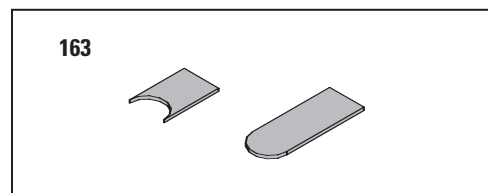
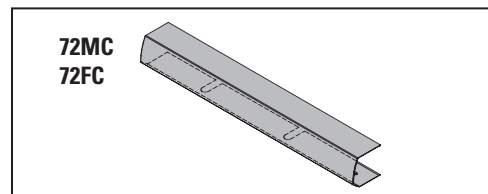
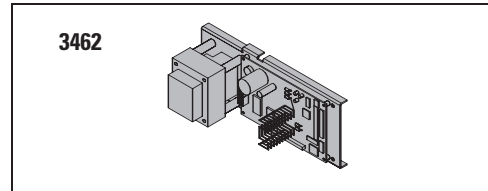
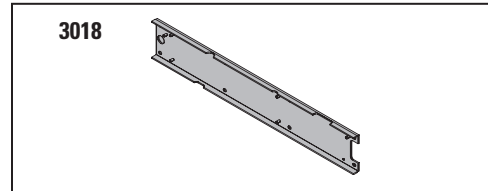
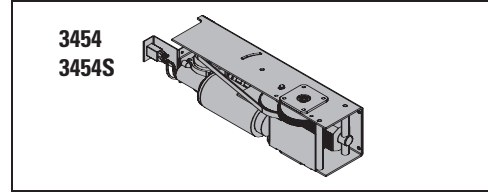

LCN 9150 SERIES

ACCESSORIES

ARMS

REGULAR ARM, 9140-3077

Non-handed arm.

LONG ARM, 9140-3077L

Non-handed long arm.

ROD & SHOE, 9140-79

Rod for use with regular arm.

LONG ROD & SHOE, 9140-79LR

Long rod for use with long arm.

INSTALLATION ACCESSORIES

HALL EFFECT ADAPTER HARNESS, 9150-3428-1

Allows a prior model motor gearbox to work with a new control box. Encoder conversion. Used with 9150-3598-1 & 9150-3430-2.

HALL EFFECT ADAPTER HARNESS, 9150-3428-2

Allows a prior model control box to work with a new motor gearbox. Encoder conversion. Used with 9150-3598-2 & 9150-3430-1.

POWER ADAPTER HARNESS, 9150-3598-1

Allows a prior model motor gearbox to work with a new control box. AC Power conversion. Used with 9150-3428-1 & 9150-3430-2.

POWER ADAPTER HARNESS, 9150-3598-2

Allows a prior model control box to work with a new motor gearbox. AC power conversion. Used with 9150-3428-2 & 9150-3430-1.

MOTOR ADAPTER CABLE, 9150-3430-1

Allows a prior model control box to work with a new motor gearbox. Motor conversion. Used with 9150-3428-2 & 9150-3598-2.

MOTOR ADAPTER CABLE, 9150-3430-2

Allows a prior model motor gearbox to work with a new control box. Motor conversion. Used with 9150-3428-1 & 9150-3598-1.

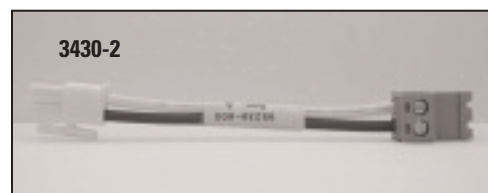
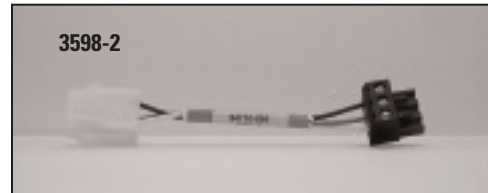
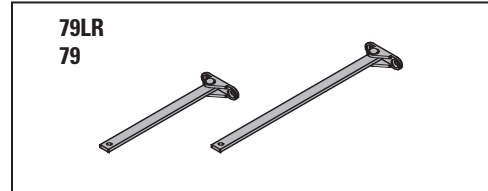
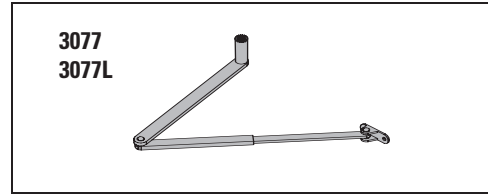
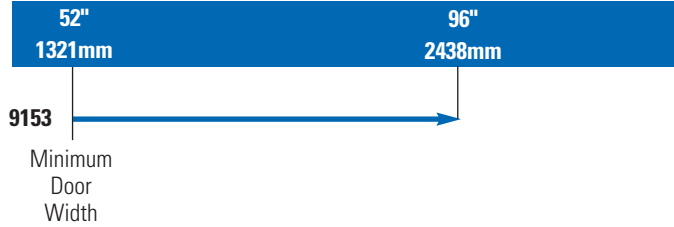

TABLE OF SIZES

→ Indicates recommended range of door width for operator.
 Note: For All Benchmark Series
 52" minimum door width for full length push double door operator.

DOOR WIDTH



HOW-TO-ORDER 9150 SERIES OPERATORS

1. SPECIFY FINISH.

- Standard Anodized Finish _____
 Aluminum or Dark Bronze

Operator will be shipped with:

- STANDARD MOTOR GEARBOX (2 ea.) (SF)
 - STANDARD CONTROL BOX (2 ea.) (SC)
 - MOUNTING BRACKET (2 ea.)
 - 72" METAL COVER (CL72)
 - REGULAR ARMS (2 ea.) (3077)
 - WOOD and MACHINE SCREW PACK
- Unless options listed below are selected.*

OPERATOR OPTIONS

COVER

- Full Cover (CL_____) (Specify length 52" to 96")

ARM

- Long Arm (3077L)
(reveals 6" to 9 3/4")

SPECIAL TEMPLATE

- ST-_____